



Energy Efficiency Kit Installation Guide

for Electric Water Heating Kits



An AEP Company

TAKE CHARGE™



Your kit includes:

- **Niagara 1.5 gpm Swivel Aerator** - Incorporates air into your water stream, effortlessly reducing water consumption without affecting pressure.
- **Niagara 1.0 gpm Faucet Aerator** - Two (2) faucet aerators to reduce water consumption without affecting water pressure.
- **Delmei 1.5 GPM Adjustable Spray Showerhead** - A 1.5 GPM showerhead to use 20% less water (while still offering great pressure!)
- **Hot Water Temperature Gauge AMC109-G** - This allows you to better gauge the efficiency of your water heater.
- **NewLeaf 8w Soft White A19 Standard Bulbs (2)** - These long-lasting LED bulbs are ideal for upgrading old incandescent bulbs in fixtures.
- **0.5w Photocell Night Light (2)** - These ultra-efficient LED night lights use 90% less electricity than an incandescent night light.



Showerhead Installation

What you'll need:

- Energy-efficient showerhead
- Pliers
- Rag (not included)

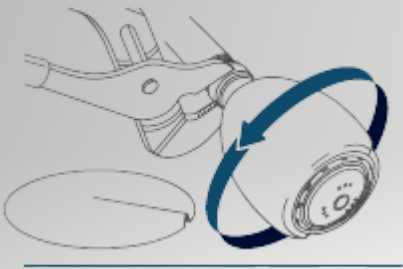

- 1.** Remove existing showerhead - Grip the base of your showerhead and turn counter-clockwise (left) to loosen. Use pliers if necessary.

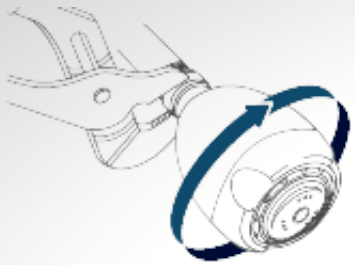

- 2.** Install your new, energy-efficient showerhead - Twist your new showerhead onto the threaded area of the shower arm in a clockwise direction (right)



- 3.** Test your Showerhead - When you turn the water on, look closely at the connection between the shower arm and the base of the showerhead collar to see if water is leaking. If so, tighten with pliers.
- 4.** Adjust water flow mode - Your new low-flow showerhead is equipped with two modes: massage and pulsating. Turn the outer ring all the way to the right for massage mode. Turn it all the way to the left for full-spray mode.



Faucet Aerator Installation

What you'll need:

- Faucet caps with aerators*
- Pliers (optional)

*If the aerator provided in this kit does not fit your faucet, call 866.807.1544 to request a free adaptor.

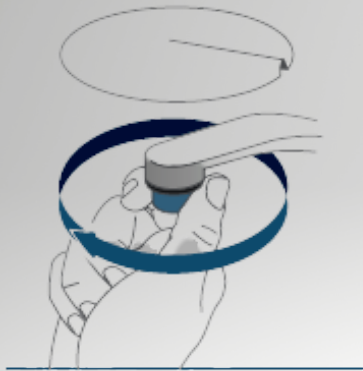

1. Remove your existing faucet cap - Unscrew the existing faucet cap. If the faucet arm has threads on the inside (female), use a male rubber washer. If it has threads on the outside (male), use a female rubber washer.



2. Install your new faucet cap with aerator - Align the threads on the inside of the faucet arm with the exterior threads of the new cap. Turn the faucet cap in a clockwise (right) direction and tighten fully.

3. Test your new aerator - While the water is flowing, look closely for any leaks at the threads. If you notice a leak or spray, tighten.

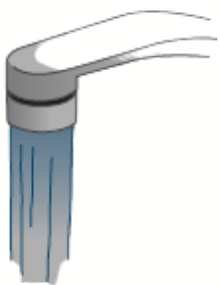

TIP: Install your new tri-flow faucet cap in your kitchen - Use the dial to adjust the flow of water at three different rates. Try using the lowest setting for hand washing, the middle setting for washing dishes, and the highest setting for filling pots or the sink.

Need help installing your energy-efficient equipment?

Contact us with questions:
TakeCharge@aep.com

Energy Efficiency Kits are available to all residential Appalachian Power customers in Virginia. One (1) kit per residential household.



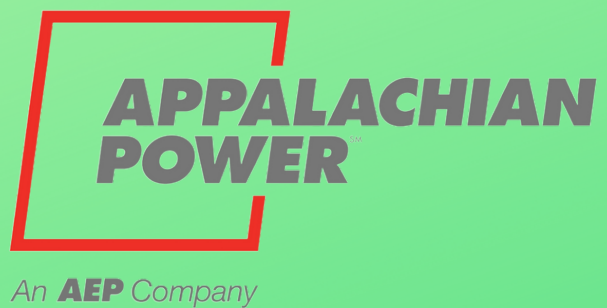

TAKE CHARGESM

TakeChargeVA.com